

INSTALLATION MANUAL

DIMENSIONS

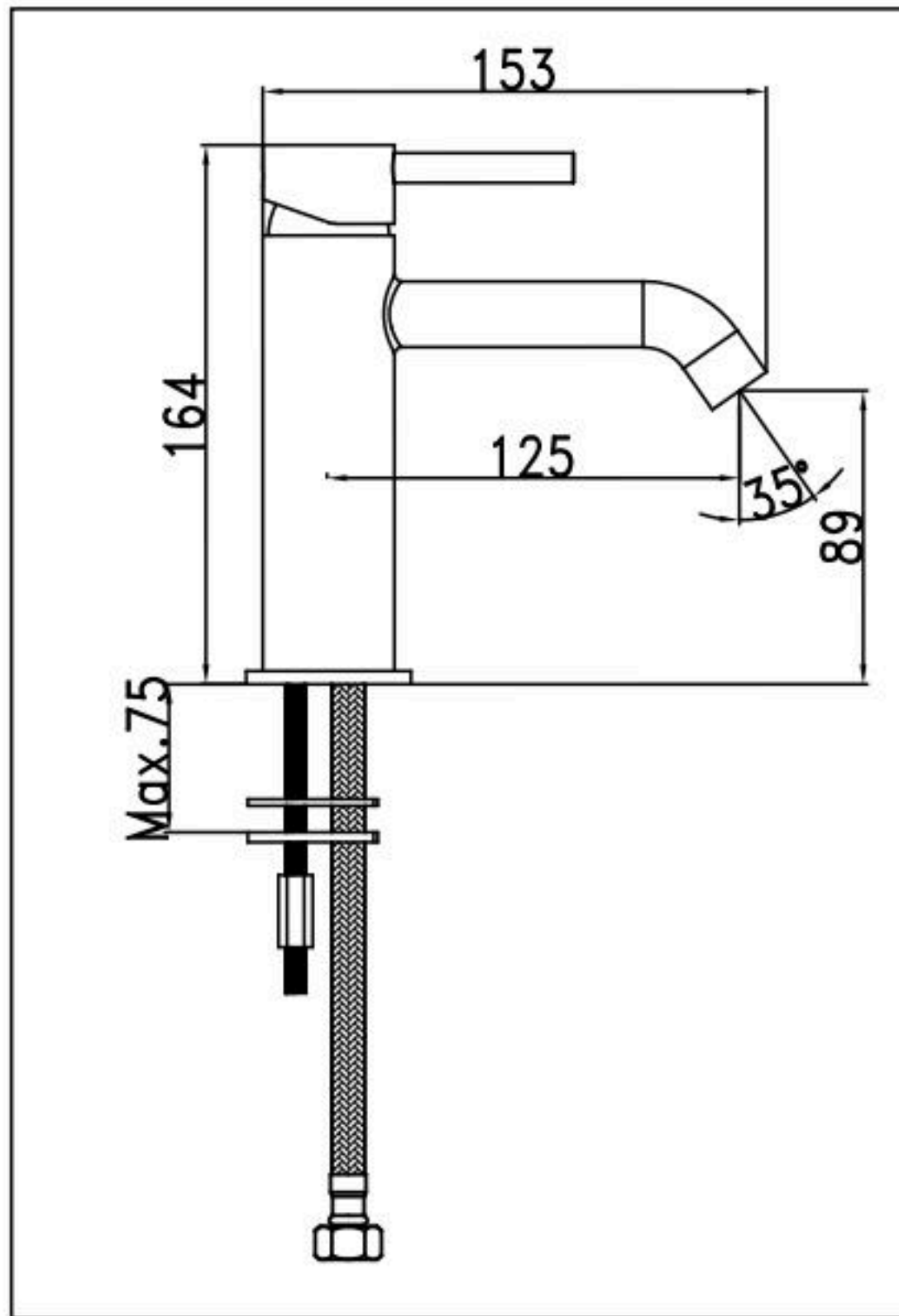

ACCESSORIES

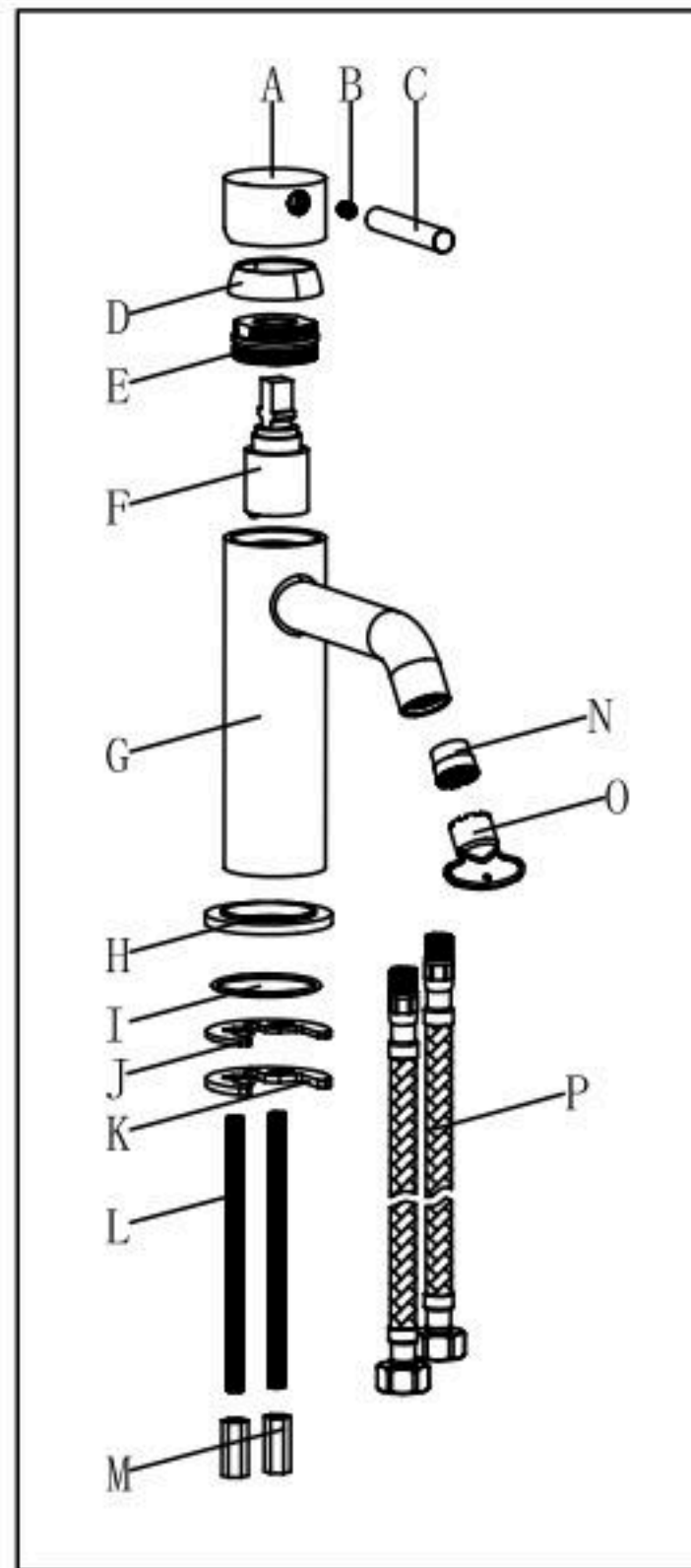

INSTALLATION PROCEDURE

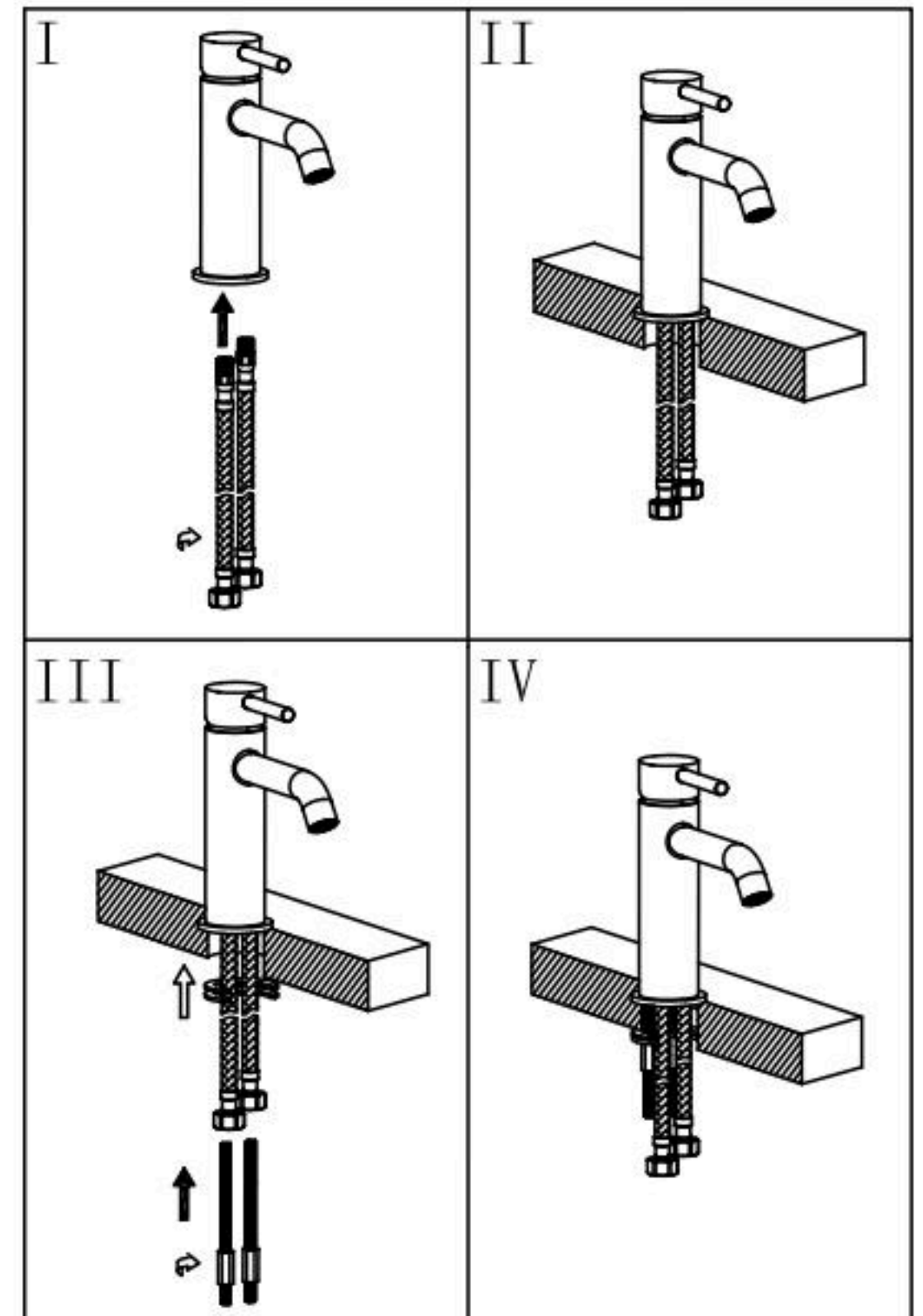

WARNING

1. After opening the package, check the accessories first. If there is any missing, please contact the local dealer immediately.
2. Before installing the faucet, please be sure to thoroughly flush through the supply pipes in order to remove any impurities.
3. Make sure there are no foul-smelling gases and decorative powder in the bathroom (because wet paint gas and wood powder will corrode the chrome plating of faucet).
4. After installation, please check the connections are tight or not, and pipes are leaking or not.

MAINTENANCE TIPS

1. Please wash the faucet by water frequently, dry with a soft cotton cloth.
2. You can use mild or colorless glass cleaner to clean the surface fouling of faucet, but can't use any acidic or abrasive cleaner.
3. Remove the aerator regularly, clean and remove impurities.